

ITI Quiz - 09-Feb-2026

10:30 AM

Q. ID: ITISKILL0999GW

February 2026

Loyola pvt ITI Vijayapur

Question Paper

Duration: 30 Mins

Total Marks: 50

ID: ITISKILL0999GW

Student Name: _____ Roll No: _____

1. A cycle consisting of one constant pressure, one constant volume and two isentropic processes is known as

- A) Diesel Cycle B) Constant pressure
C) Constant volume D) Isothermal

2. How many times, ports are open in two rotation of crank shaft in two stroke engine?

- A) Two times B) Three times
C) One time D) Four times

3. Which is the most preferred use of taper roller bearings?

- A) Fly wheel and water pump B) Connecting rods
C) Gear boxes D) Differential and wheel hub

4. What is the volume of the space above the piston at TDC?

- A) Total volume B) Swept volume
C) Clearance volume D) Displace volume

5. What is the material for cam shaft?

- A) Aluminium alloy B) Zinc alloy
C) Forged alloy steel D) Copper alloy

6. What is the angle of throw for 4 cylinder engine?

- A) 120 Degree B) 60 Degree
C) 180 Degree D) 90 Degree

7. Which ministry of India regulate the motor vehicle activity?

- A) Minister of road transport and highways B) Minister of defence
C) Minister of finance D) Minister of rural and development

8. Where the emulsion tube is provided in solex carburetor?

- A) Idle jet B) Cold starter
C) Choke D) Main jet

9. What percentage of 80 is 20?

- A) 0.4 B) 0.25
C) 0.8 D) 0.2

10. What is the specification of 6J x 15?

- A) Tyre size B) Engine size
C) Vehicle size D) Wheel rim size

11. Which is the most preferred use of roller bearings?

- A) Connecting rods B) Gear boxes
C) Differential D) Fly wheel

12. What is the property of a bearing helps to with stand metal to metal contact?

- A) Surface action B) Thermal conductivity
C) Fatigue strength D) Embeddability

13. Convert 52% into fraction?

- A) (17/25) B) (9/25)
C) (11/25) D) (13/25)

14. What type of bearing fitted in the connecting rod big end?

- A) Needle bearing B) Ball bearing
C) Taper roller bearing D) Shell bearing

15. What is the working cycle of compression ignition engine?

- A) Rankin cycle B) Diesel cycle
C) Sterling cycle D) Otto cycle

16. How many crank shaft rotations required to get one power in four stroke single cylinder diesel engine?

- A) Four B) Two
C) Three D) One

17. Which is the engine called as constant volume cycle?

- A) S.I engine B) C.I engine
C) Turbine engine D) Steam engine

18. Identify the conventional symbol of material? | ವಸ್ತುವಿನ ಕನ್ವೆಷನಲ್ ಚಿಹ್ನೆಯನ್ನು ಗುರುತಿಸಿ?

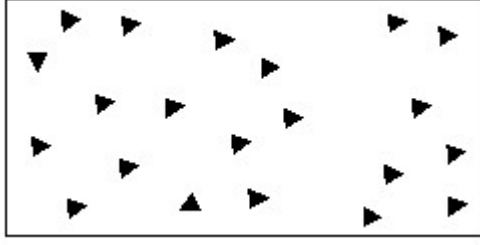

- A) Concrete | ಕಾಂಕ್ರೀಟ್ B) Wood | ಮರ
C) Steel | ಸ್ಟೀಲ್ D) Glass | ಗಾಜು

19. Identify the name of the triangle? | ತ್ರಿಕೋನದ ಹೆಸರನ್ನು ಗುರುತಿಸುವುದೇ?

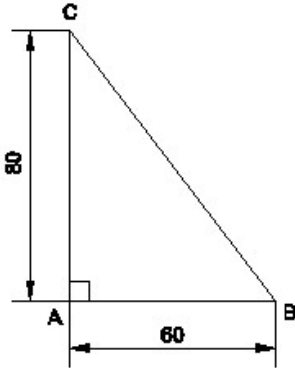

- A) Isosceles triangle | ಸಮದ್ವಿಭಾಜು ತ್ರಿಕೋನ
B) Right angle triangle | ಬಲ ಕೋನ ತ್ರಿಕೋನ
C) Equilateral triangle | ಸಮಕೋನ ತ್ರಿಕೋನ
D) Scalene triangle | ಸ್ಕೇಲಿನ್ ತ್ರಿಕೋನ

20. How the amount of work done in a specification is called?

- A) Stroke length B) Torque
C) Power D) Cycle

21. Which is connected with piston through piston pin?

- A) Gudgeon pin B) Connecting rod
C) Cam shaft D) Rocker arm

22. How much is 8% of 40 kg?

- A) 4.2 kg B) 3.2 kg
C) 2.2 kg D) 5.2 kg

23. Where is the air fuel mixture compressed in the two stroke petrol engine?

- A) Transfer port B) Intake port
C) Combustion chamber D) Exhaust port

24. Which engine has more length?

- A) Radial engine B) 'V' engine
C) Inline engine D) Opposed engine

25. Which is the key element in converting reciprocating motion in to rotary motion?

- A) Connecting rod B) King pin
C) Gudgeon pin D) Cam shaft

26. How can identify a four stroke engine?

- A) Valves B) Passages
C) Ports D) Cavities

27. Which digit indicate the engine type in 17 digit of win number?

- A) 8 digit B) 5 digit
C) 2 digit D) 3 digit

28. Which is the engine having cylinders in 180 Degree?

- A) Radial engine B) V- engine
C) Opposed engine D) Inline engine

29. How the ports are opened and closed in two stroke engine?

- A) Movement of piston B) Movement of Rocker arm
C) Movement piston pin D) Movement of valve

30. Which tool used to remove the crank shaft pully?

- A) Puller B) Double and spanner
C) Ring spanner D) Pipe wrench

31. Which part connect the piston with connecting rod?

- A) Crank pin B) Spilt pin
C) Piston pin D) Cotter pin

32. How the set of operations performed in sequence of motion of the piston in an engine produce power is called?

- A) Stroke B) Stroke
C) Cycle D) Efficiency

33. Which tool is used to measure the diameter of the crank shaft main journal?

- A) Inside micrometer B) Three point internal micrometer
C) Outside micrometer D) Master ring gauge

34. Which part is connect the piston with crank pin?

- A) Connecting rod B) Cam Shaft
C) Push rod D) Crank Shaft

35. What is the name the portion below the piston boss?

- A) Ring section of the piston B) Skirt of the piston
C) Crown of the piston D) Land of the piston

36. Which tool is required to remove the valves?

- A) Valve spring lifter B) Torque wrench
C) Scraper D) Box spanner

37. What is the ratio of 4 kg to 800 grams?

- A) 05:01 B) 02:04
C) 08:04 D) 04:08

38. Which is used to determine the stroke of an engine?

- A) Throw B) Cycle
C) Length of connecting rod D) Dia of piston

39. What is the square root of 0.017?

- A) 0.001 B) 0.000001
C) 0.00001 D) 0.13

40. Which equipment used for quick inspection under chassis of a car?

- A) Trolley jack B) Two post hoist
C) Stand D) Screw jack

41. Which measuring instrument used to check the fly wheel face out?

- A) Compression gauge B) Outside micrometer
C) Dial indicator D) Feeler gauge

42. Identify the name of tool? | ಉಪಕರಣದ ಹೆಸರನ್ನು ಗುರುತಿಸುವುದೇ?

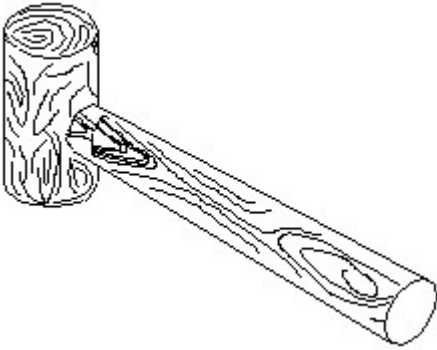

- A) Ball peen hammer | ಬಾಲ್ ಪೆನ್ ಸುತ್ತಿಗೆ B) Cross peen hammer | ಕ್ರಾಸ್ ಪೀನ್ ಸುತ್ತಿಗೆ
C) Straight peen hammer | ಸ್ಟ್ರೈಟ್ ಪೆನ್ ಸುತ್ತಿಗೆ D) Mallet | ಮ್ಯಾಲೆಟ್

43. How many crank shaft rotation required to open exhaust valve one time in four stroke engine?

- A) Two B) Three
C) Four D) One

44. What is the definition of ratio?

- A) Equality between two ratios B) Relation of two quantities of the different kind
C) Relation of two quantities of the same kind D) Inequality between two ratios

45. Which instrument is used to check the vacuum of the cylinder?

- A) Dial gauge B) Compression gauge
C) Wire gauge D) Vacuum gauge

46. Identify the conventional symbol of material? | ವಸ್ತುವಿನ ಕನ್ವೆಷನಲ್ ಚಿಹ್ನೆಯನ್ನು ಗುರುತಿಸಿ?

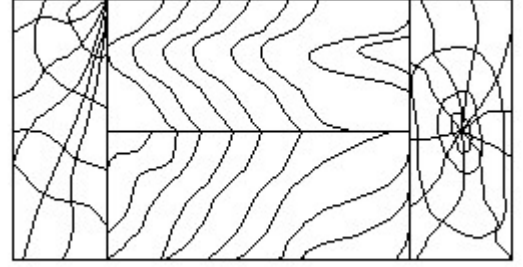

- A) Glass | ಗಾಜು B) Wood | ಮರ
C) Paper | ಪೇಪರ್ D) Lead | ಲೀಡ್

47. Which is the compression pressure of C.I engine?

- A) 180 to 280 psi B) 290 to 390 psi
C) 400 to 550 psi D) 90 to 160 psi

48. A cycle consisting of one constant pressure, one constant volume and two isentropic processes is known as

- A) Isothermal B) Constant volume
C) Constant pressure D) Diesel Cycle

49. Identify the correct aligned system dimension? | ಸರಿಯಾದ ಜೋಡಿಸಲಾದ ಸಿಸ್ಟಮ್ ಆಯಾಮವನ್ನು ಗುರುತಿಸುವುದೇ?

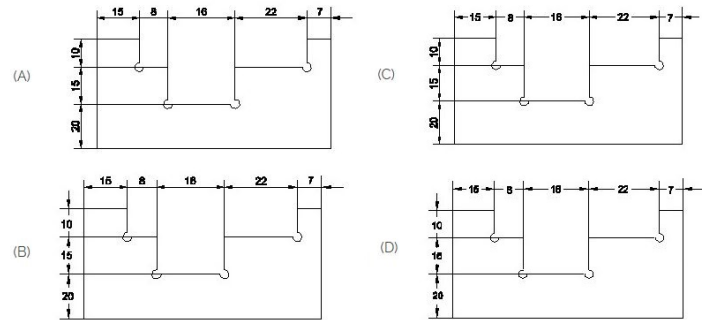

- A) C B) A
C) B D) D

50. 1). Identify the name of tool? | ಉಪಕರಣದ ಹೆಸರನ್ನು ಗುರುತಿಸುವುದೇ?

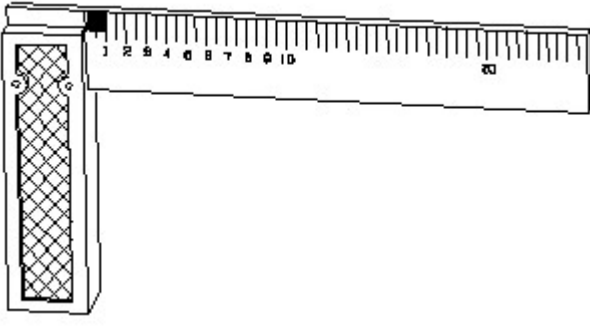

A) Steel rule | ಸ್ಟೀಲ್ ರೂಲ್

B) Surface gauge | ಮೇಲ್ಮೈ ಮಾಪಕ

C) Try square | ಟ್ರೈ ಸ್ಕ್ವೇರ್

D) Feeler gauge | ಫೀಲರ್ ಗೇಜ್